

# Worsen Dale & Stonetable Hill

Grade :   
 Length : 2.5 miles ( 4 km )  
 Start/End Point : Bishop Wilton Village  
 Refreshments : Shop & Pub in Bishop Wilton  
 Toilets : The Square, Stamford Bridge

1 cm equals 0.07 km  
 1 cm equals 0.04 miles

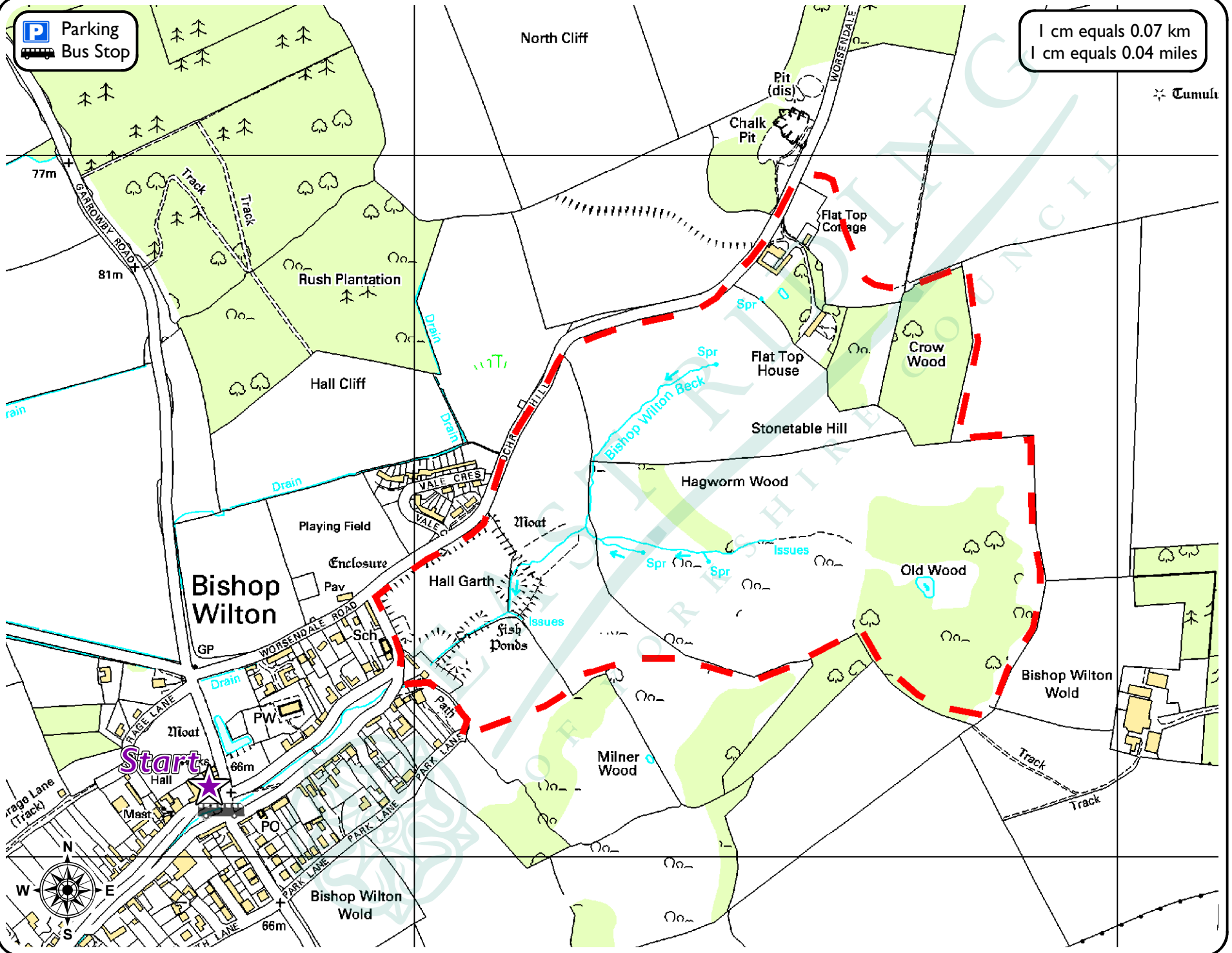

This map is reproduced from Ordnance Survey material with the permission of Ordnance Survey on behalf of Her Majesty's Stationery Office Crown copyright 2008. Unauthorised reproduction infringes Crown copyright and may lead to prosecution or civil proceedings. East Riding of Yorkshire Council 100023383.